



Webster Lake

A P A R T M E N T S





Webster Lake Apartments...



A place where *kids can be kids, and parents can relax.* Where convenience, affordability and recreation blend together to create a comfortable lifestyle.

Stroll through our courtyards, or take a dip in one of our two swimming pools. Enjoy the convenience of having a *lake in your own backyard* and take advantage of all that E.B. Reins Park has to offer – directly behind Webster Lake Apartments. Such activities include fishing, nature watching or just relaxing waterside.

Webster Lake Apartments are within *walking distance of Northglenn Recreation Center*, fine restaurants abound and easy access to I-25 and downtown Denver.

Community Features

- ❖ Garages
- ❖ Spacious Floor Plans
- ❖ Private Entry
- ❖ Large Private Patio or Balcony
- ❖ Bright Step Saver Kitchen
- ❖ All Utilities Paid
(Except Electricity)
- ❖ Garbage Disposals
- ❖ Central Air Conditioning
- ❖ Large Storage Areas
- ❖ Laundry Facilities
Conveniently Located
- ❖ Two Swimming Pools
- ❖ Grassy Courtyards
- ❖ Picnic Area
- ❖ Play Ground

As Unique As You Are.

2 Bedroom

750 Sq. Ft. with 4x6 Storage Area

Monthly Rent _____

Deposit _____

Pet Charge _____

Application Fee _____

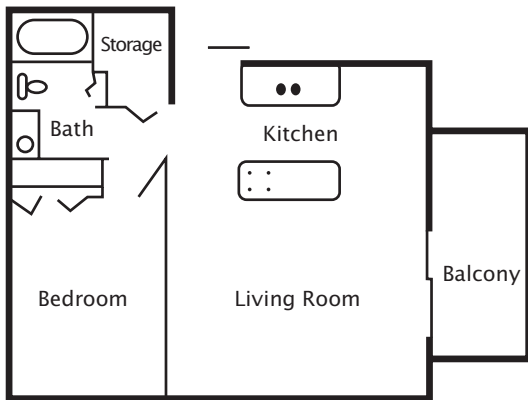

1 Bedroom

555 Sq. Ft. with 4x6 Storage Area

Monthly Rent _____

Deposit _____

Pet Charge _____

Application Fee _____

